

# SILTWRM GENERAL NOTES

SILTWRM IS A GEOTEXTILE WITH A NOMINAL DENSITY OF 45 G/SM<sup>2</sup> OR 1.35 LB/SM<sup>2</sup>. IT IS MADE OF POLYPROPYLENE AND WILL BECOME OPAQUE IN SOME INSTANCES. THIS IS THE STATED HEIGHT VALUE LESS MINIMUM DENSITY.

## MATERIAL SPECIFICATIONS

**METHODS:**  
SILTWRM IS A TUBULAR NET HIGH-DENSITY POLYPROPYLENE.  
BY A NON-OPENED MATERIAL CONSISTING OF WOOD CHIPS, BARK FREE SOFTWOOD THAT IS 100% RECYCLED.

## APPLICATIONS

SILTWRM CAN BE PLACED IN DITCHES OR AT THE TOP, ON THE FACE OR AT THE TOW OF SLOPES AS SEGMENT TRAPPING DEVICES. THEY CAN ALSO SERVE TO REMOVE SEGMENT FROM RUNOFF AND RELEASE IT AS SHEET FLOW.

### PERIMETER CONTROL

PLACE SILTWRM DIRECTLY ON TOP OF GRADE AND OVERLAP RIGGS A MINIMUM OF 6" SITE PREPARATION IS MINIMAL AND THERE IS NO STAKING OR TRENCHING REQUIREMENT FOR GRADES UNDER 15% EXCEPT FOR 6" DIAMETER WHICH SHOULD BE STAKED EVERY 4' AT 45 DEGREE ANGLE INTO GRADE. SLOPES OVER 15% SHOULD BE STAKED EVERY 4' IN A MANNER THAT IS APPLIED PERPENDICULAR TO SHEET FLOW WITH A CONSISTENT GRADE CONTACT.

### SLOPE INTERUPTION

SILTWRM SHOULD BE INSTALLED WITH A SLIGHT ENRICHMENT OF SOIL AND STAKED EVERY 6' IN THE SLOPE. FOR DITCH APPLICATIONS, THE MINIMUM DRAINAGE AREA SHALL BE 5 ACRES. AT SITES WHICH DO NOT MEET THIS REQUIREMENT, THE MINIMUM DRAINAGE AREA SHALL BE LIMITED TO 15 ACRES.

SILTWRM SHALL BE PLACED PERPENDICULAR TO THE FLOW OF WATER. SILTWRM SHALL CONTINUE TO BE PLACED PERPENDICULAR TO THE FLOW OF WATER WITH A MINIMUM OF 10' BETWEEN EACH RIGHT ANGLE TURN UNTIL ALL UPSTREAM AREAS ARE PERMANENTLY STABILIZED.

### DITCH CHECK

SILTWRM SHOULD BE INSTALLED WITH A SLIGHT ENRICHMENT OF SOIL AND STAKED EVERY 4' IN THE DITCH CHECK APPLICATION. 6" DIAMETER NOT RECOMMENDED.

FOR DITCH APPLICATIONS, THE MINIMUM DRAINAGE AREA SHALL BE 5 ACRES. AT SITES WHICH DO NOT MEET THIS REQUIREMENT, THE MINIMUM DRAINAGE AREA SHALL BE LIMITED TO 15 ACRES.

SILTWRM SHALL BE PLACED PERPENDICULAR TO THE FLOW OF WATER. SILTWRM SHALL CONTINUE TO BE PLACED PERPENDICULAR TO THE FLOW OF WATER WITH A MINIMUM OF 10' BETWEEN EACH RIGHT ANGLE TURN UNTIL ALL UPSTREAM AREAS ARE PERMANENTLY STABILIZED.

## REMOVAL

**SILTWRM SHALL BE REMOVED FROM SLOPES, DITCHES, PERIMETER, OR INLETS AFTER STABILIZATION IS COMPLETE. THIS MAY BE ACCOMPLISHED BY CUTTING THE SOCK OPEN AND BREAKING THE FILL MATERIAL ON THE SITE.**

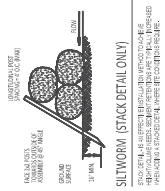

**SILTWRM (STACK DETAIL ONLY)**  
SILTWRM IS A TUBULAR NET HIGH-DENSITY POLYPROPYLENE. IT IS MADE OF POLYPROPYLENE AND WILL BECOME OPAQUE IN SOME INSTANCES. THIS IS THE STATED HEIGHT VALUE LESS MINIMUM DENSITY.

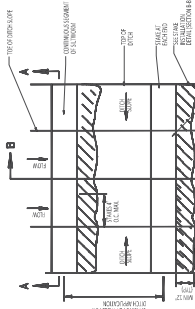

**PLAN VIEW FOR DITCH APPLICATION**

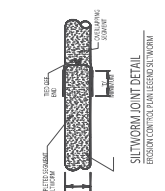

**SILTWRM JOINT DETAIL**  
DITCH CHECK APPLICATION

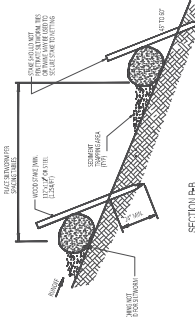

**SECTION 1-1**

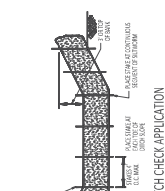

**DITCH CHECK APPLICATION**

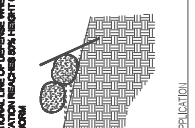

**ADDITIONAL USE OF DEFENSE WHEN SEPARATION REQUIRES EXHAUSTIVE USE OF THE SILTWRM**

- MAINTENANCE APPLICATION**
1. Sediment Control/Retention: Siltworm that has exposed filtering and retention capacity. Sediment retention capacity is reduced when sedimentation reaches 20% of the height of the Siltworm, maintenance or replacement is required. Siltworm is an open filter, it is not a barrier.
  2. Slope Erosion: In the event that the Siltworm is an open filter, it is not a barrier, it is not a barrier, it is not a barrier.
  3. Sediment Control/Retention: Siltworm that has exposed filtering and retention capacity. Sediment retention capacity is reduced when sedimentation reaches 20% of the height of the Siltworm, maintenance or replacement is required. Siltworm is an open filter, it is not a barrier.

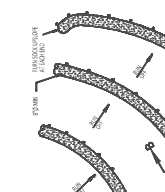

**PLAN VIEW FOR SLOPE APPLICATION**

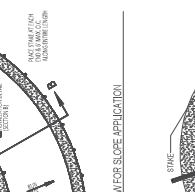

**CATCH BASIN APPLICATION**

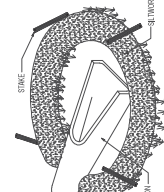

**LANDSCAPE APPLICATION**

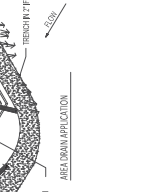
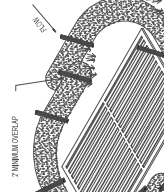
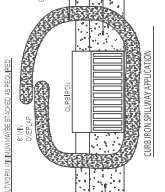

NO. OF SILTWRM	INSTALLER'S HEIGHT OF SILTWRM	HEIGHT OF SILTWRM	HEIGHT OF SILTWRM
6"	4.5"	5"	5"
8"	5.5"	6"	6"
10"	6.5"	7"	7"

PROPERTY	PH	5.0-6.5	6.0
MOISTURE CONTENT	15-18%	18-20%	20-22%
ORGANIC MATTER CONTENT	10-15%	15-20%	20-25%
PHYSICAL CONTAMINANTS	10-15%	15-20%	20-25%
PARTICLE SIZE	2 INCHES - 70% 40% 1/4 INCH - 20% 30% 1/8 INCH - 10% 20% 1/2"		

SILTWRM CHECK DAM ESTIMATED QUANTITIES			
LENGTH (FT)	12"	18"	24"
100	60	40	20
200	120	80	40
300	180	120	60

(1) ESTIMATED QUANTITIES BASED ON 4:1 SLOPE. QUANTITIES MAY VARY BASED ON ACTUAL SLOPE COMPARISON.  
(2) QUANTITIES WILL VARY BASED ON ACTUAL SLOPE COMPARISON.

SILTWRM SPACING FOR SLOPE APPLICATION	
SLOPE	MAXIMUM SPACING
LESS THAN 2%	80'
2%	60'
4%	50'
6%	40'
GREATER THAN 6%	20'

SILTWRM SPACING FOR DITCH APPLICATION	
SLOPE	MAXIMUM SPACING
LESS THAN 2%	80'
2%	60'
4%	50'
6%	40'
GREATER THAN 6%	20'

NOTE: NOT RECOMMENDED SPACING FOR DITCH APPLICATION.